

Inch

Screw Size	"R" Style	"H" Style	Hex A/F	A/F inch/mm	D inch/mm	Length inch/mm
2, 3	HP-1/8-R	HP-1/8-H	1/8	.119/3.02	.313/7.94	1.250/31.75
4, 5	HP-3/16-R	HP-3/16-H	3/16	.179/4.55	.375/9.53	1.250/31.75
4, 5	HP-3/16-1-R	HP-3/16-1-H	3/16	.179/4.55	.313/7.94	1.250/31.75
6, 8	HP-1/4-R	HP-1/4-H	1/4	.242/6.15	.375/9.53	1.250/31.75
6, 8	HP-1/4-1-R	HP-1/4-1-H	1/4	.242/6.15	.313/7.94	1.250/31.75
10, 12	HP-5/16-R	HP-5/16-H	5/16	.302/7.67	.375/9.53	1.250/31.75
1/4	HP-3/8-R	HP-3/8-H	3/8	.364/9.25	.500/12.70	2.000/50.80
5/16	HP-7/16-R	HP-7/16-H	1/2	.425/10.80	.500/12.70	2.250/57.15
5/16	HP-1/2-R	HP-1/2-H	1/2	.487/12.37	.625/15.88	2.250/57.15
3/8	HP-9/16-R	HP-9/16-H	9/16	.548/13.92	.625/15.88	2.250/57.15

Metric

Screw Size	"R" Style	"H" Style	Hex A/F	A/F inch/mm	D inch/mm	Length inch/mm
3mm	MHP-4-R	MHP-4-H	4mm	.150/3.81	.312/7.92	1.250/31.75
3.5mm	MHP-5-R	MHP-5-H	5mm	.189/4.80	.312/7.92	1.250/31.75
4mm	MHP-5.5-R	MHP-5.5-H	5.5mm	.209/5.31	.312/7.92	1.250/31.75
	MHP-6-R	MHP-6-H	6mm	.226/5.74	.312/7.92	1.250/31.75
5mm	MHP-7-R	MHP-7-H	7mm	.265/6.73	.375/9.53	1.250/31.75
	MHP-7-1-R	MHP-7-1-H	7mm	.265/6.73	.312/7.92	1.250/31.75
6mm	MHP-8-R	MHP-8-H	8mm	.305/7.75	.375/9.53	2.000/50.80
8mm	MHP-10-R	MHP-10-H	10mm	.383/9.73	.500/12.70	2.000/50.80
10mm	MHP-12-R	MHP-12-H	12mm	.461/11.71	.625/15.88	2.250/57.15
10mm	MHP-13-R	MHP-13-H	13mm	.499/12.67	.625/15.88	2.250/57.15
12mm	MHP-15-R	MHP-15-H	15mm	.578/14.68	.750/19.05	2.250/57.15

1. M2 Material at RC 59-61
2. Pins available with Raised or Depressed headmarking per request.
3. PVD coating coatings available.

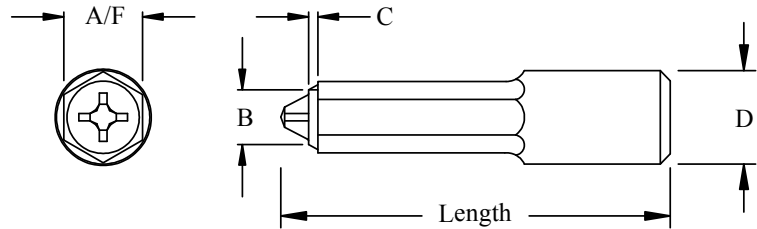

Phillips Indented Hexagon Pins

Screw Size	Part Number	Recess Type	A	B	C	D	Length	Recess Penetration
			inch/mm	inch/mm	inch/mm	inch/mm	inch/mm	
6	PHP-1/4-3P20-1	3P20-1	.242/6.15	.210/5.33	.012/.30	.313/7.94	1.250/31.75	.077/.089
8	PHP-1/4-3P20-2	3P20-2	.242/6.15	.210/5.33	.018/.46	.375/9.53	1.250/31.75	.103/.115
10	PHP-5/16-3P20-6	3P20-6	.302/7.67	.270/6.86	.020/.51	.375/9.53	1.250/31.75	.115/.127
1/4	PHP-3/8-3P30-3	3P30-3	.364/9.25	.320/8.13	.030/.76	.500/12.70	1.250/31.75	.174/.186
1/4	PHP-7/16-3P30-3	3P30-3	.425/10.80	.381/9.68	.030/.76	.500/12.70	1.250/31.75	.174/.186

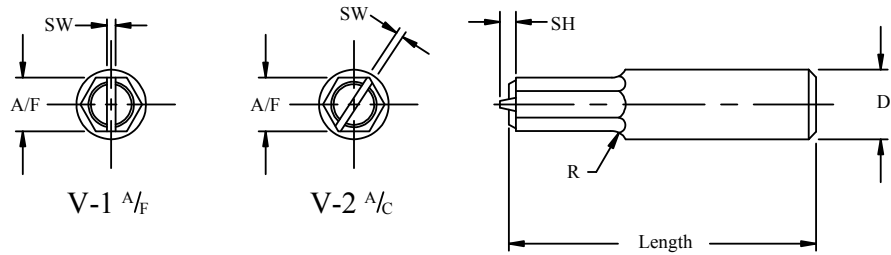

Combination/Slotted

Screw Size	Part Number	Hex A/F	A/F	D	Length	SW	SH
			inch/mm	inch/mm	inch/mm	inch/mm	inch/mm
4	HP-3/16-SS	3/16	.179/4.55	.375/9.53	1.25/31.75	.019/.48	.034/.086
6	HP-1/4-SS	1/4	.242/6.15	.375/9.53	1.25/31.75	.025/.64	.043/1.09
8	HP-1/4-1-SS	1/4	.242/6.15	.313/7.94	1.25/31.75	.045/1.14	.049/1.24
10	HP-5/16-SS	5/16	.302/7.67	.375/9.53	1.25/31.75	.036/.91	.054/1.37
1/4	HP-3/8-SS	3/8	.364/9.25	.500/12.70	2.00/50.80	.053/1.35	.068/1.73
1/4	HP-7/16-SS	7/16	.425/10.80	.500/12.70	2.25/57.15	.053/1.35	.068/1.73
5/16	HP-1/2-SS	1/2	.487/12.37	.625/15.88	2.25/57.15	.051/1.30	.077/1.96
3/8	HP-9/16-SS	9/16	.548/13.92	.625/15.88	2.25/57.15	.084/2.13	.077/1.96

1. M2 Material at RC 60-62.
2. Pins available with Raised or Depressed headmarking per request.
3. PVD coating coatings available.